

1
2 THRU 4

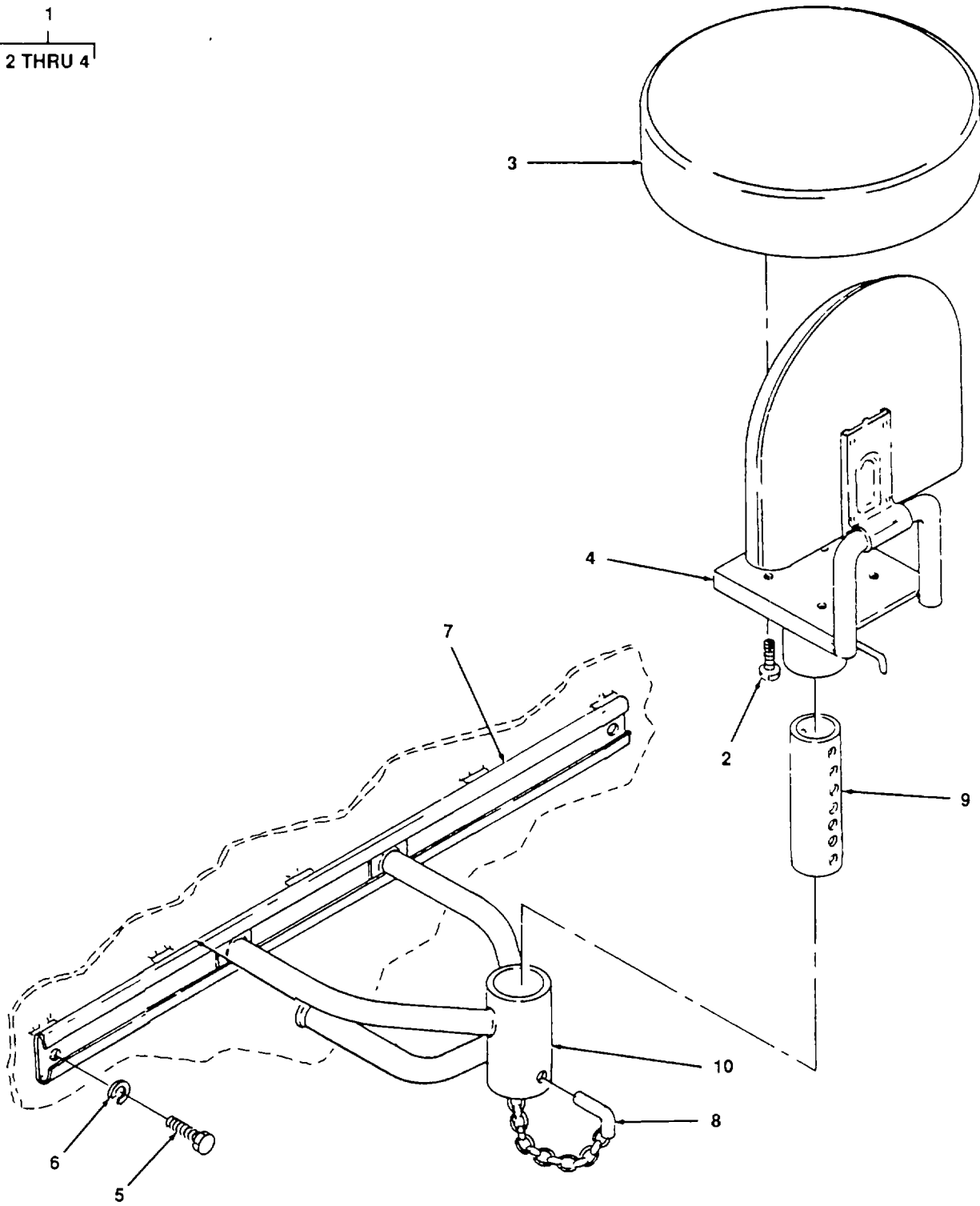
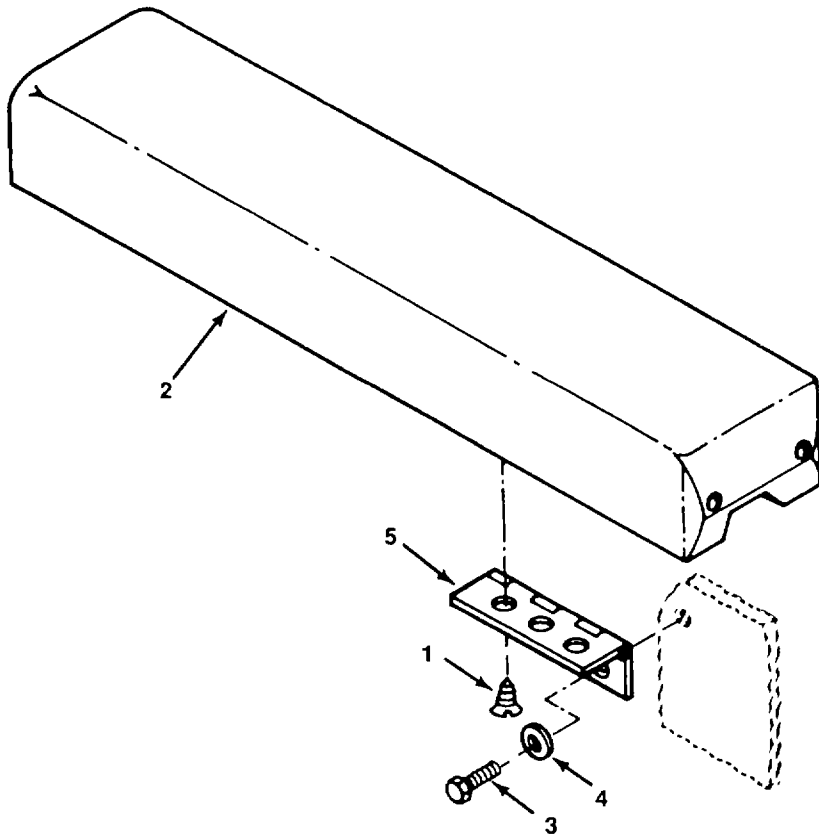

Figure 6. Seat and Mounting Bracket.

SECTION II

TM 55-2210-224-24P

(1) ITEM NO.	(2) FSCM	(3) PART NUMBER	(4) DESCRIPTION AND USABLE ON CODE	(5) QTY
			GROUP 02 CAB GROUP	
			FIG 6 SEAT AND BRACKET	
1	72915	9087100	SEAT ASSEMBLY	1
2	96906		SCREW	4
3	72915		SEAT W/BRACKET	1
4	72915		BASE, SEAT	1
5	96906	MS90725-55	SCREW, HEX 3/8 X 1/2 (NSN 5305-00-269-3206)	2
6	96906	MS35338-46	WASHER, LOCK 3/8	2
7	72915		TRACK ASSEMBLY, SEAT	1
8	72915		PIN W/CHAIN	1
9	72915		TUBE, ADJUSTING	1
10	72915	8346783	BRACKET, SUPPORT	1
			END OF FIGURE	



4834 007

Figure 7. Arm Rest.

(1) ITEM NO.	(2) FSCM	(3) PART NUMBER	(4) DESCRIPTION AND USABLE ON CODE	(5) QTY
1	96906		GROUP 02 CAB GROUP	
			FIG 7 ARMREST	
2	96906	24-2-343	SCREW, WOOD, 1 1/2 IN NO 8	6
3	74096	MS35206	(NSN 5305-00-722-4630)	
4	96906	ARMREST	SCREW, PAN HEAD 10-24 X 5/8 IN	1
5	96906	MS27183-21	SCREW, PAN HEAD 10-24 X 5/8 IN	6
	39428	MS27183-21	WASHER, FLAT, 5/8 IN (NSN 5310-00-823-8803)	6
		1581H999	HINGES, 6 IN X 2 IN 2	
			END OF FIGURE	